



ShivAM ENGINEERING

Mfg.: Stainless Steel Tube Mill Machine

INTRODUCTION

Welcome To Shivam Engineering, We Stand Ahead In The Line Of reputed Manufacturers Of Stainless Steel Tube Mill Machine, Stainless Steel Round Tube Polish Machine, Stainless Steel Square Tube Polish Machine, Tube Straightening Machine, Rolls For Tube Mill, Bead Rolling System For Stainless Steel Tube Mill, Hydrostatic Test Bench,

We Established in the year 2005, In Gujarat's Engineering Hub City, Ahmedabad, Area Vatva, GIDC Industrial area. We have Successfully Made Our Reputation to stand a side as a leading supplier along with a manufacturer Of the Stainless Steel Tube Mill Machine.

MANAGEMENT

Our Management base comprises various functional units like procurement, manufacturing, quality testing, research & development, sales & marketing and Warehousing & packaging. All units are armed with requisite amenities in order meet bulk orders of clients.

MARKETING

Our Sales Professional Are Knowledgeable In all Processes And Capabilities Inabilities them to be responsive to customer's demands and requirements. They work directly with the engineering and production team to serve as your advocate. Our team of dexterous professionals supervises the activities of all units. Moreover, we also conduct crucial training sessions and seminars for our team of professionals in order to keep them abreast with latest technological advancement.

MANUFACTURING & FACILITIES

Our Manufacturing & Facilities we equipped our 5000sq meter large workshop with most modern CNC machines and other specialized machinery & tooling. With our past experience in making one of the best Tube mills, we quickly achieved position par excellence in other related machineries as well. Proprietary control over all manufacturing aspects ensures quality product delivery in fasteners time.

Assembly Line:

Valuable guidance, Mr. Kalpesh Patel & Mukesh Patel of Assembly Line Consisting of Pneumatic Tools in a dust free and clean workshop environment.

OUR MISSION

We believe In Quality And Our Vision is to satisfy customers by using our high quality products and excellent customers services.

OUR VISION

Our vision is to develop Innovative techniques for manufacturing Stainless Steel Round Tube Polish machine to be recognized as global leader in our industry and to ensure that we meet the committed deliverable to clients, ensure employee satisfactions and be recognized in the society as an organization of ethics.

STAINLESS STEEL TUBE & PIPE MACHINE



1. Tube Mills For Various Grades Of Stainless Steel.
2. Emphasis On: Material Selection
Manufacturing Process Selection Dimensional & Geometrical Accuracy
3. Cross Key Ways For Permanent Alignment Of Forming & Sizing Stands On The Base Frames.
4. Shafts From Alloy Steel, Duly Heat Treated, Ground, Hard – Chrome Plated & Ground Again.
5. Idler Roll Stand Assembly Designed For Vertical Height Adjustment While The Mill Is In Operation.
6. Screw Down Movement Of Turk's Head Rolls Link – Pin Mechanism For Ease In Reforming Thick Walled Sections.
7. W-Forming System in Roll Design For Better Edge – Forming & Freedom From Wrinkle While Forming Sizes With Adverse T/D Ratio.
8. Bead Rolling System With Hydraulic Operation For Continuous Rolling Inside Bead Of Welding Operation.
9. Duty Heat Treated & Ground Rolls From HighCarbon High Chromium (HUHC), Finished on CNC.

● **Over 120 installation in India.**



Bead Rolling

Tooling



Model Name	Tube Size Range		Tube Thickness	
	MIN OD	MAX OD	Min	Max
SHIVAM 15TM	6mm	16mm	0.3	1.0
SHIVAM 25TM	9mm	25mm	0.4	1.6
SHIVAM 40TM	9mm	40mm	0.6	2.0
SHIVAM 50TM	12mm	51mm	0.6	2.5
SHIVAM 65TM	12mm	65mm	0.6	2.5
SHIVAM 65TM	15mm	65mm	0.8	3.5
SHIVAM 76TM	20mm	76mm	0.8	3.0
SHIVAM 100TM	25mm	100mm	1.2	3.5
SHIVAM 115TM	25mm	115mm	1.2	4.0
SHIVAM 140TM	32mm	141mm	1.6	5.4
SHIVAM 170TM	50mm	168mm	2.0	6.0

STRAIGHTENING MACHINE

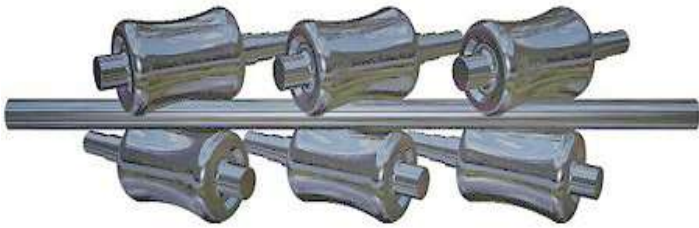

- Tube Straightening Machine For Ferrous & Non-Ferrous Metals
- Emphasis On: Material Selection
- Manufacturing Process Selection
- Dimensional & Geometrical Accuracy
 - 3x3 Skew Roll Design
 - 5x5 Skew Roll Design
- M.S. Fabricated & Duty Stress Relieved Top & Bottom Main Frames
- All The Guiding Holes In Main Frames For Roll Brackets & Supporting Columns Machined In Single Setting
- Single Piece Integrated Roll Bracket Design
- Rolls Supported On Two Matched Pair Taper Roller Bearing On Each Side

● **Over 43 installation in India.**

Model Name	Tube Size Range		Tube Thickness
	MIN OD	MAX OD	MAX
Shivam 15 ST	6 mm	16 mm	1.5mm
Shivam 25 ST	9 mm	25 mm	2.0mm
Shivam 50 ST	12 mm	51 mm	3.2mm
Shivam 65 ST	15 mm	65 mm	4.0mm
Shivam 76 ST	20 mm	76 mm	4.0mm
Shivam 100 ST	25mm	101mm	6.0mm
Shivam 170 ST	50mm	168mm	7.0mm

TUBE POLISH MACHINE



We provide an efficient range of Tube Polishing Machine which is used for polishing round bar and tube. Designed in compliance with international quality standards, this machine is available in different models such as single head, two head, three head, four head and multi head machines. Our ranges of polishing machines are available in both standard and customized form according to the client's specification.

SPECIFICATIONS :-

- Tubes Stainless Steel & Copper & Copper Alloy, Seamless Tubes Polish Machine.
- It can achieve Matte / Mirror finish with emery flap wheels & buffing wheels on stainless steel.
- Suitable for grinding, polishing & buffing of kitchenware, stainless steel, Brass, aluminum. Pipes (Tube) & rods, furniture, wooden industries and small components.
- Round Polish Machine Manufacturing by 1 head to 12 head Model.

● **Over 96 installation in India.**

Model Name	Tube Size Range		Tube Thickness
	MIN OD	MAX OD	MAX
Shivam 50 PM	12 mm	50 mm	2.5mm
Shivam 76 PM	12 mm	76 mm	3.0mm
Shivam 100 PM-H	12 mm	100 mm	3.5mm
Shivam 127 PM	25 mm	127 mm	6mm
Shivam 170 PM	50 mm	168 mm	7mm

TUBE SQUARE & RIGHT ANGLE POLISH MACHINE



We Provide An Efficient Range Of Tube Polishing Machine Which Is Used For Polishing Round Bar and Tube. Designed In Compliance With International Quality Standards, This Machine Is Available in Different Models Such as Single Head, Two Head, Three Head, Four Head and Multi Head Machines. Our Ranges Of Polishing Machines are Available In Both Standard And Customized Form According To The Client's Specification.

SPECIFICATIONS :-

- Tubes Stainless Steel & Copper & Copper Alloy, Seamless Tubes Polish Machine.
- It can achieve Matte / Mirror finish with emery flap wheels & buffing wheels on stainless steel.
- Suitable for grinding, polishing & buffing of kitchenware, stainless steel, Brass, aluminum. Pipes (tubes) & rods, furniture, wooden industries and small components.
- Square Polish Machine Manufacturing by 1 head to 32 head Model.

● **Over 45 installation in India.**

Model Name	Tube Size Range		Tube Thickness
	MIN SQ	MAX SQ	MAX
Shivam 50 PM	12X12 mm	50X50 mm	2.5
Shivam 76 PM	12X12 mm	80X80 mm	3.0
Shivam 100 PM	20X20 mm	100X100 mm	3.5
Shivam 150 PM	25X25 mm	150X150 mm	5.2
Shivam 200 PM	50X50 mm	200X200 mm	6.0

PRODUCTS



Tube Mill Machine For Stainless Steel



Stainless Steel Polish Machine



Stainless Steel Square Machine



Hydraulic Test Bench Tube



Tube Number Punching Machine



Tube Brushing Machine



S. S. tube Straightrning Machine



Turk Head Assembly



Bead Rolling Machine



3 X 3 Skew Roll design

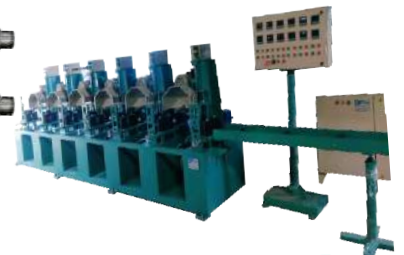

Square Tube Polish Machine



Tooling



Stainless Steel Regular Tube



Slitting Line Cutter ..

Belt Griender machine



Product Range

- Tube Mill For Stainless Steel

Tube Mill For S.S. Thin Walled Tube

Bead Rolling Systems For S.S. Tube Mill

Rolls For Tube Mill

- Tube Polish Machine

For Round Tube

For Square And Rectangular Tube

- Tube Straightening Machine

3 X 3 Skew Roll Design

5 X 5 Skew Roll Design

- Bead Rolling Systems For S.S. Tube Mill

- Roll For Tube Mills

- Hydraulic Test Bench Tube

- Slitting Line Cutter

- Belt Grinder Machine For Tube Mill

- Tube Brushing Machine

- Tube Number Punching Machine

- Turk head Assembly

For Square And Rectangular ,Ovel

- Stainless Steel Tube Square machine



Shivam Engineering

Mfg.: Stainless Steel Tube Mill Machine

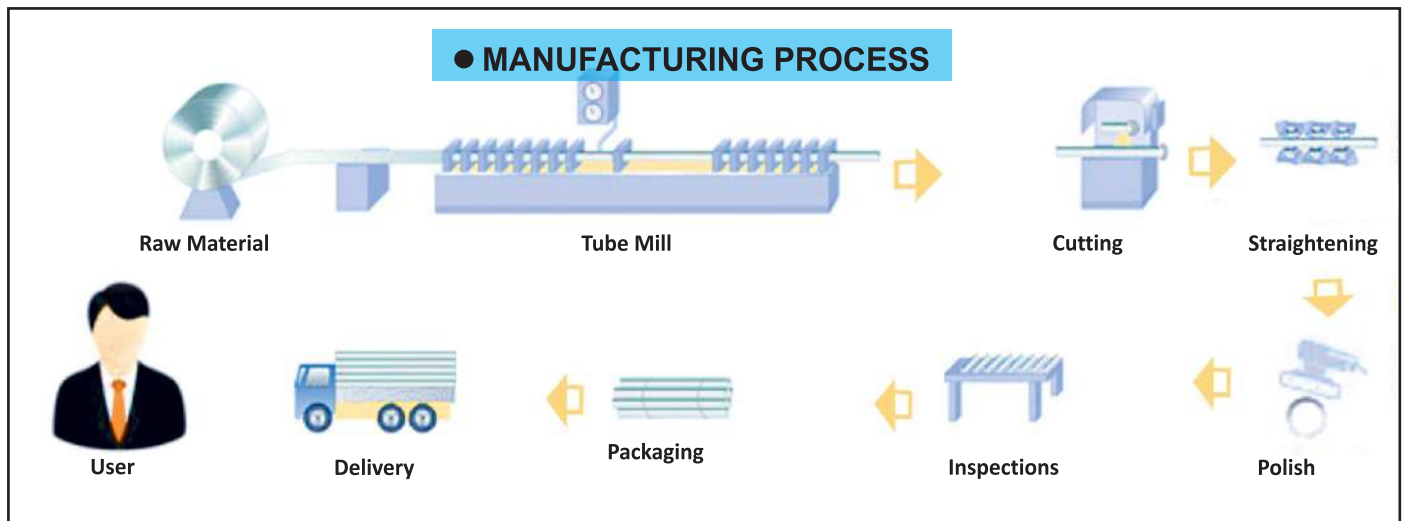

Mr. Kalpesh Patel
Mr. Mukesh Patel



+91 9879958336
+91 9824267536



info@shivamengineerings.com
info@sstubemill.net



www.shivamengineerings.com
www.sstubemill.net



16, Shayona Ind Estate, Nr. Panchratna Estate, Ramol Bridge,
Ramol Chowkdi, Vatva, Ahmedabad-382445. (Gujarat)

OUR EXPORT NETWORK
Domestic



Scan This Qr Code Your
Apps & Android Smart Phone



Save The Water
Save Tree

